

STREET MAP TOWN OF FREEDOM

OUTAGAMIE COUNTY, WISCONSIN

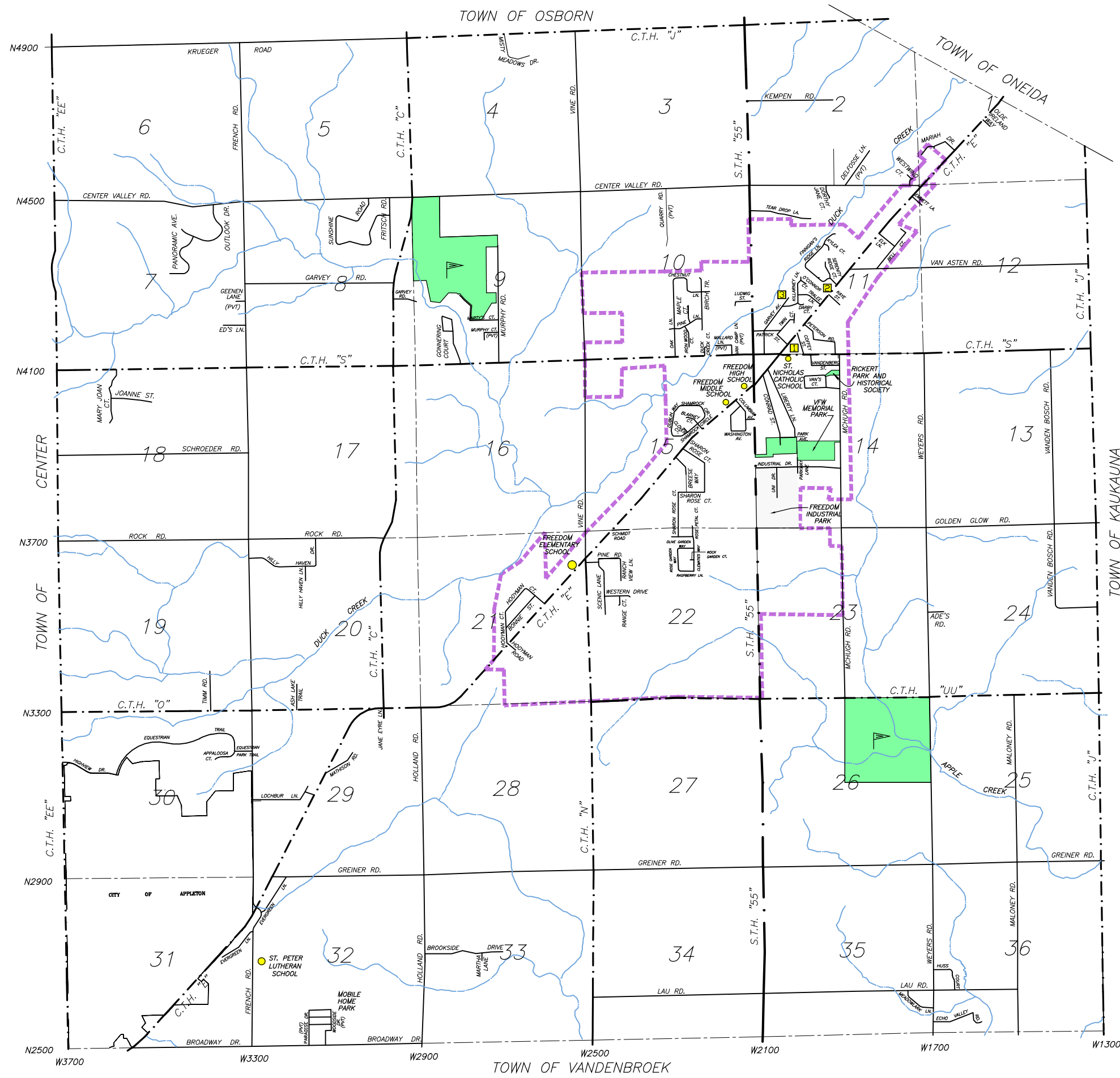
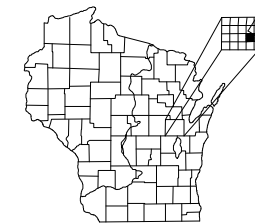
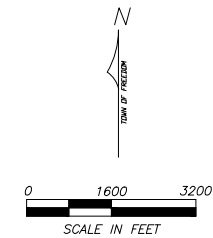

STREET NAMES	SEC.	LOCATION	STREET NAMES	SEC.	LOCATION
ADE'S ROAD	24		MARY JOAN COURT	18	
ASH LAKE TRAIL	20		MATHISON ROAD	29	
APPALOOSA CT.	30		MCHUGH ROAD	14,23	
			MEADOWLARK LANE	35	
BELL COURT	11		MISTY MEADOWS DRIVE	4	
BIRCH TRAIL	10		MURPHY COURT (PVT)	9	
BLARNEY COURT	15		MURPHY ROAD	9	
BONNIE STREET	21				
BREEZE WAY	15		OAK LANE	10	
BROADWAY DRIVE	31,32		O'CONNOR COURT	11	
BROOKSIDE DRIVE	33		OLDE IRELAND WAY	1	
			OLIVE GARDEN WAY	22	
CENTER VALLEY ROAD	2-11		OUTLOOK DRIVE	7	
CHESTNUT LANE	10				
CLEMATIS WAY	22		PANORAMIC AVENUE	7	
CLOVER COURT	15		PARADISE DRIVE (PVT)	32	
COFFEY STREET	11		PARK AVENUE	14	
COLUMBIA AVENUE	15		PARKWAY LANE	14	
CONRAD STREET	14		PATRICK STREET	11	
			PETERSON ROAD	11	
DARBY COURT	11		PINE LANE	10	
DELFOSE LANE (PVT)	2		PINE ROAD	22	
DOROTHY JANE COURT	11				
DUBLIN WAY	15		QUARRY ROAD (PVT)	10	
DUCK CREEK COURT	10				
			RANCH VIEW LANE	22	
ECHO VALLEY ROAD	36		RANGE COURT	22	
ED'S LANE	7		RASPBERRY LANE	22	
ELK LANE	11		ROCK ROAD	17-20	
EMMETT LANE	11		ROCK GARDEN COURT	22	
EVERGREEN LANE	31,32		ROSE GARDEN WAY	22	
EQUESTRIAN PARK TRAIL	30		ROSE PETAL COURT	22	
EQUESTRIAN TRAIL	30				
			SCENIC LANE	22	
FINNIGANS RIDGE LANE	11		SCHMIDT ROAD	15,22	
FRENCH ROAD	5-8,17-20,29-32		SCHROEDER ROAD	18	
FRITSCH ROAD	8		SERENITY RIDGE COURT	11	
			SHAMROCK CIRCLE	15	
GARVEY AVENUE	11		SHARON ROSE COURT	15,22	
GARVEY ROAD	8		SUNSHINE ROAD	8	
GEENEN LANE (PVT)	7				
GOLDEN GLOW ROAD	13,14,23,24		TEAR DROP LANE	11	
GONNERING COURT	9		TIMM ROAD	19	
GREINER ROAD	25-29,32-36		TRALEE LANE	11	
			TWIN COURT	11	
HIGHVIEW DR.	30		UNI DRIVE	14	
HILLY HAVEN DRIVE	20				
HILLY HAVEN LANE	20		VAN ASTEN ROAD	11,12	
HOLLAND ROAD	28,29,32,33		VAN CAMP LANE (PVT)	10	
HOOYMAN COURT	21		VANDENBERG STREET	14	
HOOYMAN ROAD	21		VANDEN BOSCH ROAD	13,24	
HUSS COURT	36		VAN'S COURT	14	
			VINE ROAD	3,4,9,10,15,16,21,22	
INDUSTRIAL DRIVE	14				
IRONWOOD COURT	10		WASHINGTON AVENUE	15	
			WEYERS ROAD	13,14,23-26,35,36	
JANE EYRE LANE	29		WESTERN DRIVE	22	
JOANNE STREET	18		WESTWIND COURT	2	
KAYE STREET	11		WOODSIDE DRIVE (PVT)	32	
KEMPEN ROAD	2				
KILLARNEY LANE	11		COUNTY TRUNK HIGHWAY "C"	4,5,8,9,17,20	
KRUEGER ROAD	5,6		COUNTY TRUNK HIGHWAY "E"	1,11,14,15,20,21	
KYLEA COURT	11		COUNTY TRUNK HIGHWAY "EE"	29,31,32	
			COUNTY TRUNK HIGHWAY "J"	1-6,12,13,24,25,36	
LAU ROAD	34-36		COUNTY TRUNK HIGHWAY "N"	21,22,27,28,33,34	
LIBERTY LANE	14		COUNTY TRUNK HIGHWAY "O"	19,20,29,30	
LOCHBUR LANE	29		COUNTY TRUNK HIGHWAY "S"	7-18	
LUDWIG STREET	10		COUNTY TRUNK HIGHWAY "UU"	22-27	
MALONEY ROAD	25,36		STATE HIGHWAY "55"	2,3,10,11,14,15,22,23,26,27,34,35	
MALLARD LANE (PVT)	10				
MAPLE COURT	10				
MARIAH DRIVE	1				
MARTHA LANE	33				
MARTY'S COURT	9				

- TOWN OF FREEDOM
- TOWN HALL 788-4548
 - FIRE DEPARTMENT 687-1776
 - EMERGENCY 911
 - POLICE DEPARTMENT 788-0902
 - EMERGENCY 911
 - TOWN GARAGE 788-5538
 - SANITARY DISTRICT NO. 1 788-5763
- SANITARY DISTRICT BOUNDARY
- GOLF COURSES
- STREET ADDRESSES N4900 / W3700